

17 1/2 TON HYDRAULIC PULLER SET

To Parts List

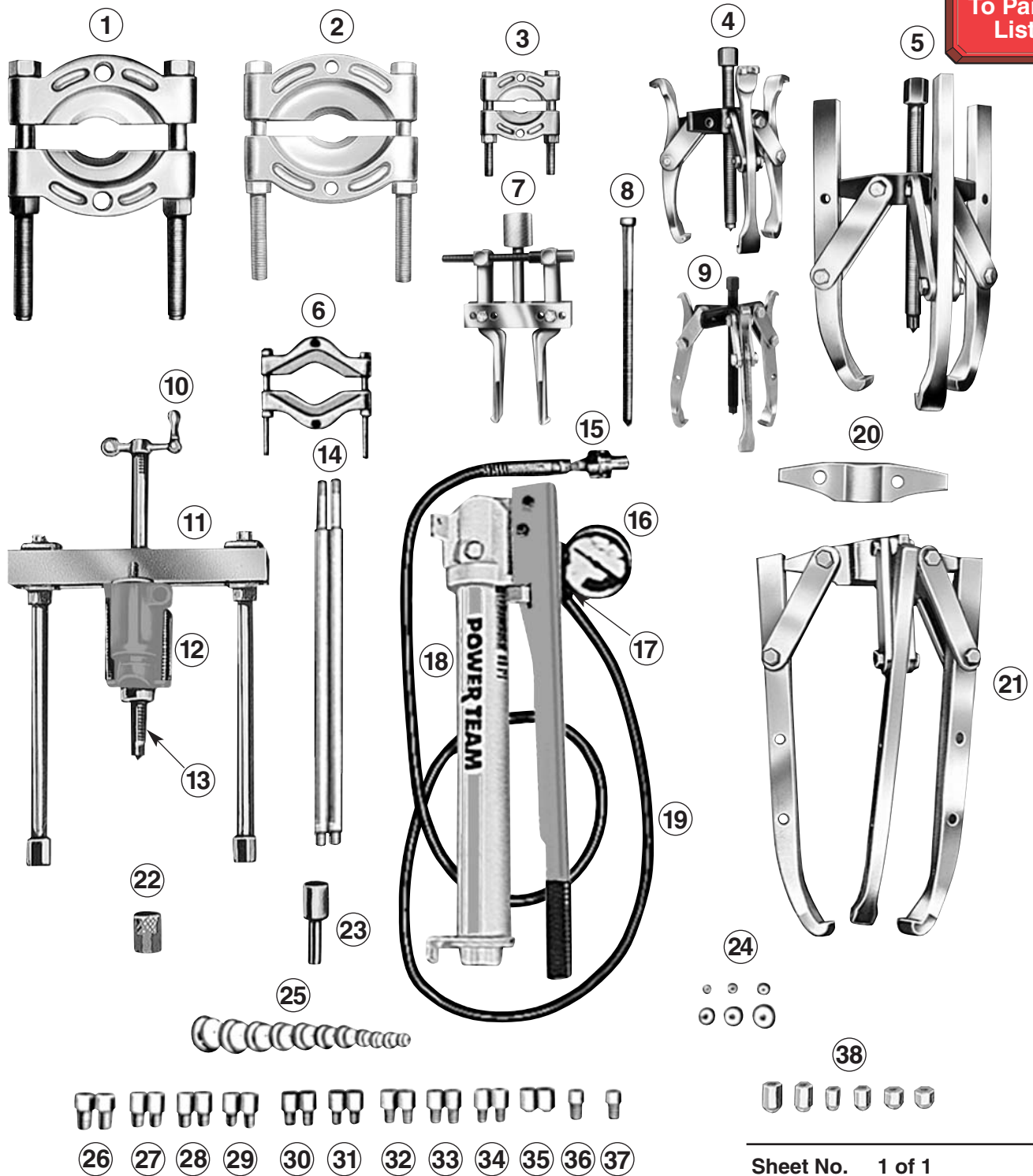

Parts List, Form No. 101762, Back sheet 1 of 1

Item No.	Part No.	No. Req'd	Description
1	1130	1	Bearing Pulling Attachment
2	1123	1	Bearing Pulling Attachment
3	1122	1	Bearing Pulling Attachment
4	1037	1	Combination Puller (2/3 jaw)
5	1041	1	Combination Puller (2/3 jaw)
6	679	1	Pulley Pulling Attachment
7	1154	1	Bearing Cup Pulling Attachment
8	24832	1	Puller Screw
9	1027	1	Combination Puller (2/3 jaw)
10	24814	1	Speed Crank
11	1062	1	Push-puller (17 1/2 ton; 16 1/2" legs)
12	RT172	1	Cylinder With Threaded Insert (17 1/2 ton)
13	32118	1	Adjusting Screw
14	1105	1 pr.	Puller Legs (22 1/2")
15	9798	1	Hose Half Coupler
16	9059	1	Pressure Gauge
17	9670	1	Tee Adapter
18	P55	1	Hand Pump Assembly (Single-stage)
19	9767	1	Hydraulic Hose 6'
20	41224	1	Puller Head (17 1/2 ton; 2 jaw)
21	1066	1	Puller (17 1/2 ton; 3 jaw)
22	28228	1	Cylinder Cap
23	201923	1	Pushing Adapter
24	8056	6 pcs.	Shaft Protector Set
25	8075	11 pcs.	Step Plate Adapter Set
26	8005	2	Male-Female Threaded Adapters (5/8 - 18 F. X 3/8 - 16 M.)
27	8006	2	Male-Female Threaded Adapters (5/8 - 18 F. X 1/2 - 20 M.)
28	8007	2	Male-Female Threaded Adapters (5/8 - 18 F. X 1/2 - 13 M.)
29	8010	2	Male-Female Threaded Adapters (5/8 - 18 F. X 5/8 - 11 M.)
30	8013	2	Male-Female Threaded Adapters (5/8 - 18 F. X 3/4 - 16 M.)
31	8015	2	Male-Female Threaded Adapters (5/8 - 18 F. X 3/4 - 10 M.)
32	8017	2	Male-Female Threaded Adapters (5/8 - 18 F. X 7/8 - 14 M.)
33	8018	2	Male-Female Threaded Adapters (5/8 - 18 F. X 7/8 - 9 M.)
34	8019	2	Male-Female Threaded Adapters (5/8 - 18 F. X 1" - 14 M.)
35	8038	2	Female Threaded Adapter (5/8 - 18 X 3/4 - 16)
36	8020	1	Male-Female Threaded Adapters (1" - 8 F. X 5/8 - 18 M.)
37	8021	1	Male-Female Threaded Adapters (1" - 8 F. X 1" - 14 M.)
38	8044	6 pcs.	Female Threaded Adapter Set

